

Polatrak Deep C Meter™ 300

General

The Polatrak Deep-C-Meter 300 is designed for service on an inspection class ROV. The unit is ROV powered and provides continuous visual output. Rated for operation in up to 1,000 feet (300 m) depth, this system can be used for any inspection. The instrument readout unit can be conveniently mounted anywhere on the ROV, and the probe unit is held in the tee-handle manipulator mount. The Deep C Meter kit includes an ROV II probe, an articulated mount, standard whips and all standard replacement parts.

Specifications

Depth rating	1,000 ft [300 m]
Operating temp.	1°C to 55°C
Voltage range	+1999 mV to -1999 mV
Input resistance	10 M-Ohm
Power supply	9-volt battery

Electrode elements*

ROV-II has two electrode elements which are interchangeable to suit specific water environments

Ag/AgCl (Silver/silver chloride)

Material	Ag/AgCl with Silver Wire Core
Dimensions	Ø 0.3" x 1.8" [Ø 8 mm x 45 mm]
Accuracy	± 5 mV
Applications	Seawater (15 to 150 ohm-cm)

Cu/CuSO4 (Copper/copper sulphate)

Material	Cu/CuSO4 with copper wire core
Dimensions	Ø 0.3" x 1.4" [Ø 8 mm x 36 mm]
Accuracy	± 5 mV
Applications	Fresh water / Slightly brackish water (150 to 300,000 ohm-cm)

*Ag/AgCl elements provided as standard

Standard kit components

Offshore storm case, Deep C Meter 300, ROV-II probe, Zn calibration coupon, spare electrode, tips and o-rings. Additional spares and replacements are available upon request.

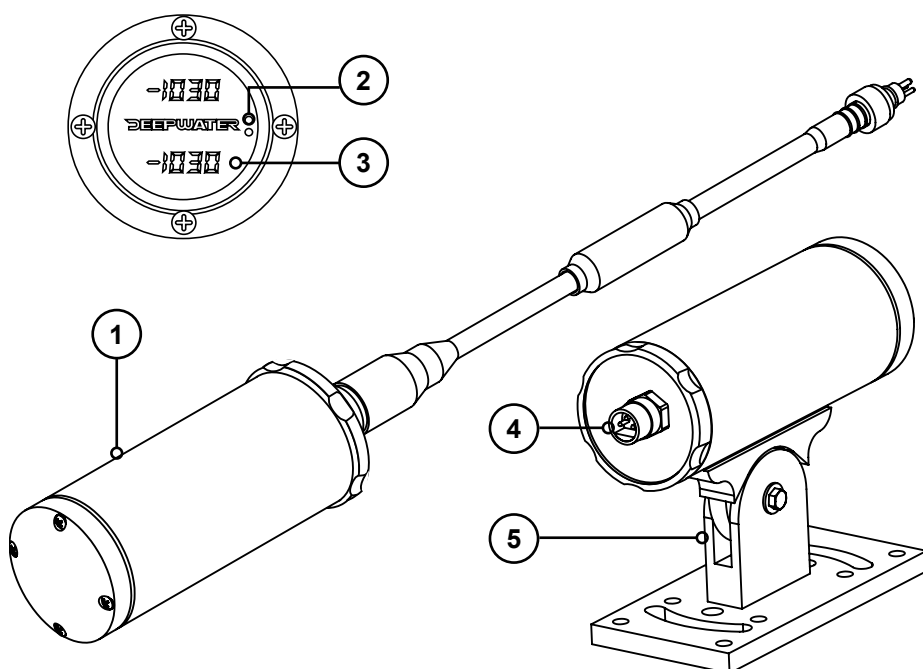

Overall weights & dimensions

Deep C Meter

Dimensions (Ø x L)	Ø 3.5" x 5.5" [89 x 178 mm]
Weight (Air)	2 lb [.9 kg]
Weight (Water)	.5 lb [.23 kg]

Main body

Pressure housing (Item 1)

Material	Delrin
Internal components	LED readouts

Photo diode switch (Item 2)

Lens assembly (Item 3)

Material	Clear acrylic
Dimensions	Ø 3.5" x 0.9" [Ø 89 mm x 23 mm]
Seal	2 No. O-rings, 1 No. B/U ring
Fixings	4 No. SS316 retaining screws
Display	3 No. 4 digit 0.4" [10 mm] ultra bright blue LED display

Meter mount (Item 5)

Material	Delrin
----------	--------

Pin interface (Item 4)

Pin 1	Contact tip
Pin 3	Electrode #2
Pin 2	Electrode #2

Offshore transit case

Dimensions (W x H x D)	25" x 20" x 12" [635 x 508 x 305 mm]
Packed weight	45 lb [9.5 kg]

ROV-II contact tip (Item 6)

Material	Stainless Steel 316 pointed tip
Dimensions	60° point, 0.75" [19 mm] long, 0.38" [10 mm] A/F
Features	Fully replaceable

